

APPENDIX B

Emergency Discharge Sites

See notes in Section 4.1 regarding the potential need to modify / augment over-pumping sites to deal with future flood events. Over-pumping sites will be selected to provide the most effective arrangements to maintain services, whilst minimising environmental effects. Where practical, sites that have been used previously are expected to be re-used (when necessary), but the use of different locations cannot be ruled out, if hydraulic conditions dictate.

B1. Ickham, Nailbourne, Kent – Overpumping and Tankering Sites

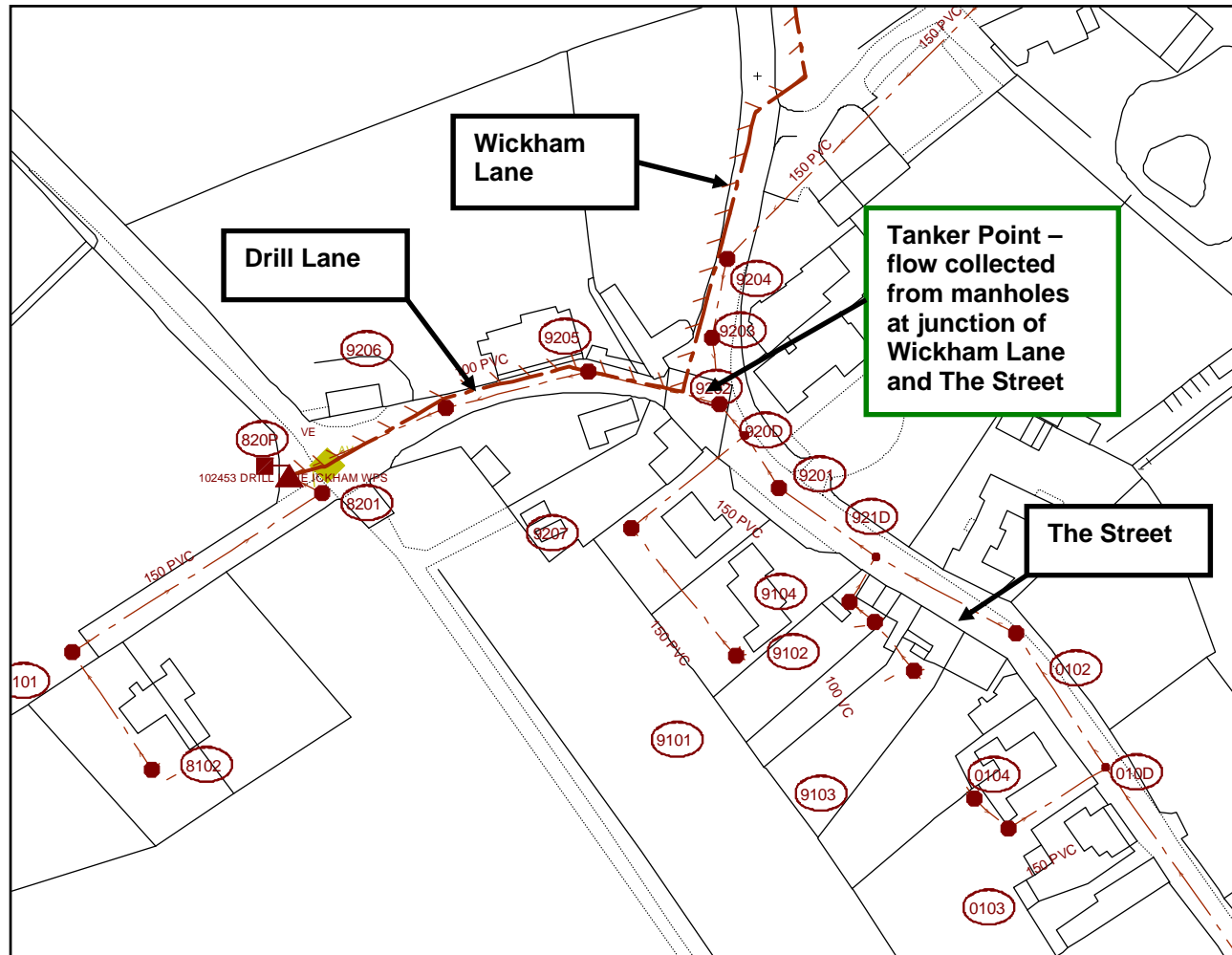

B2. Littlebourne, Nailbourne, Kent – Over-pumping and Tankering Sites (1 of 2)

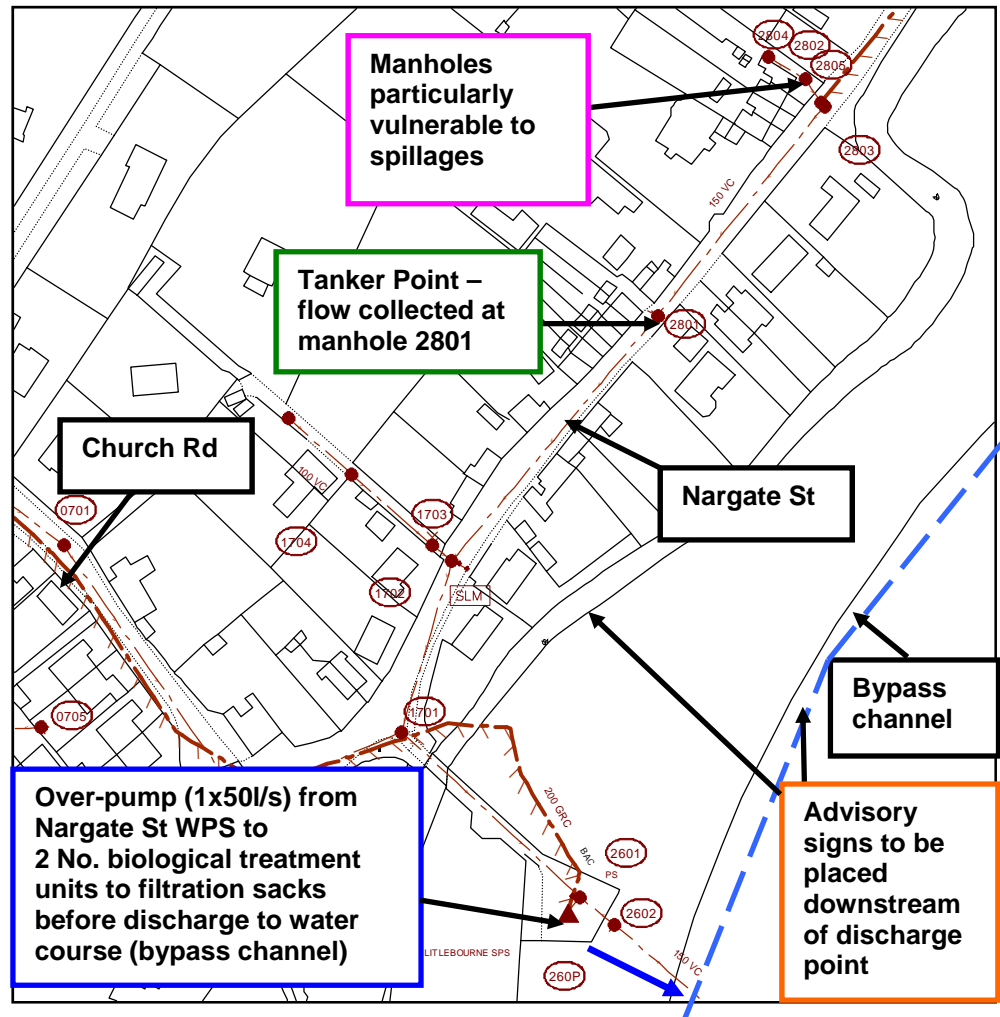

B3. Littlebourne, Nailbourne, Kent – Over-pumping and Tankering Sites (Plan 2 of 2)

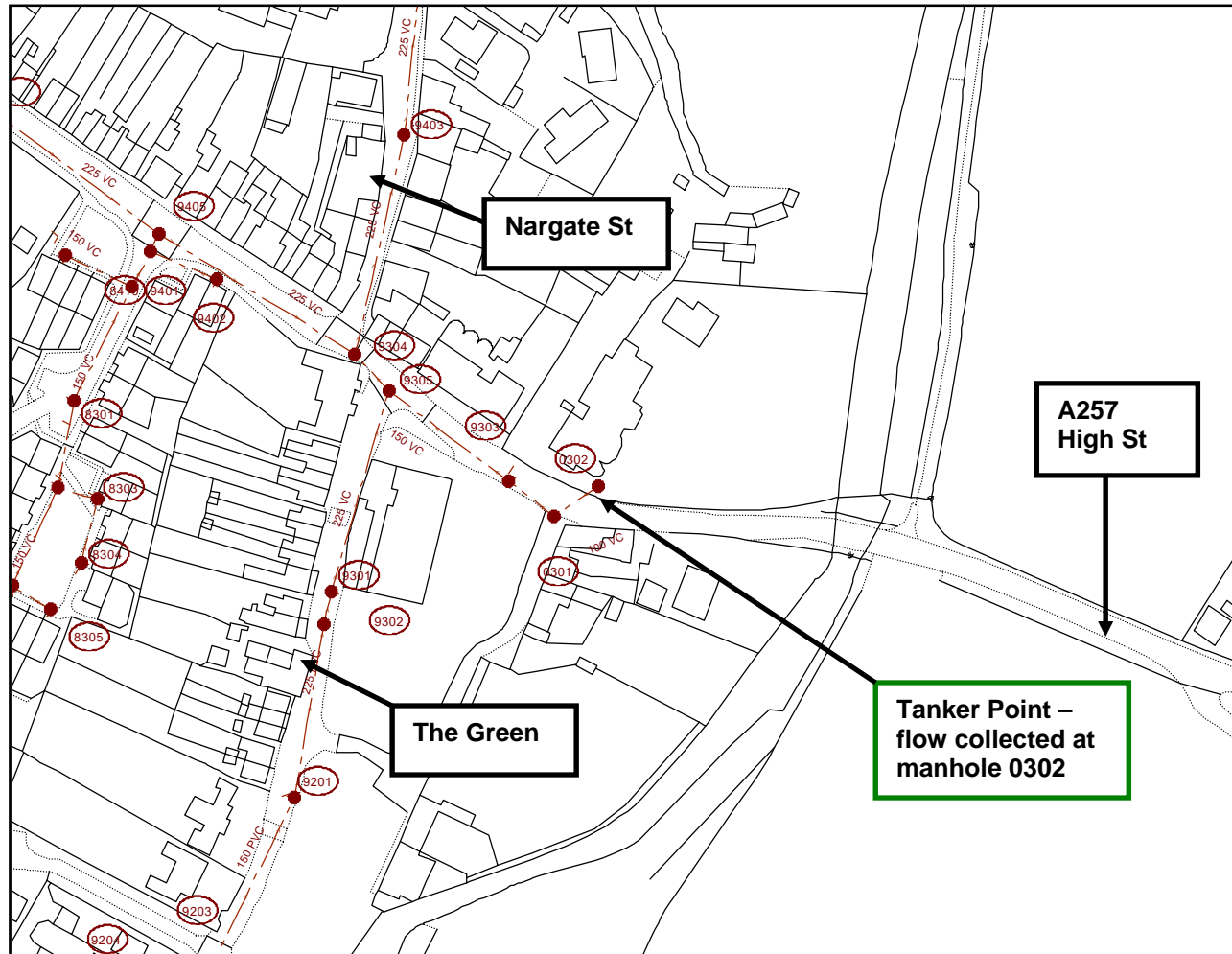

B4. Bekesbourne, Nailbourne, Kent – Over-pumping and Tankering Sites (Plan 1 of 1)

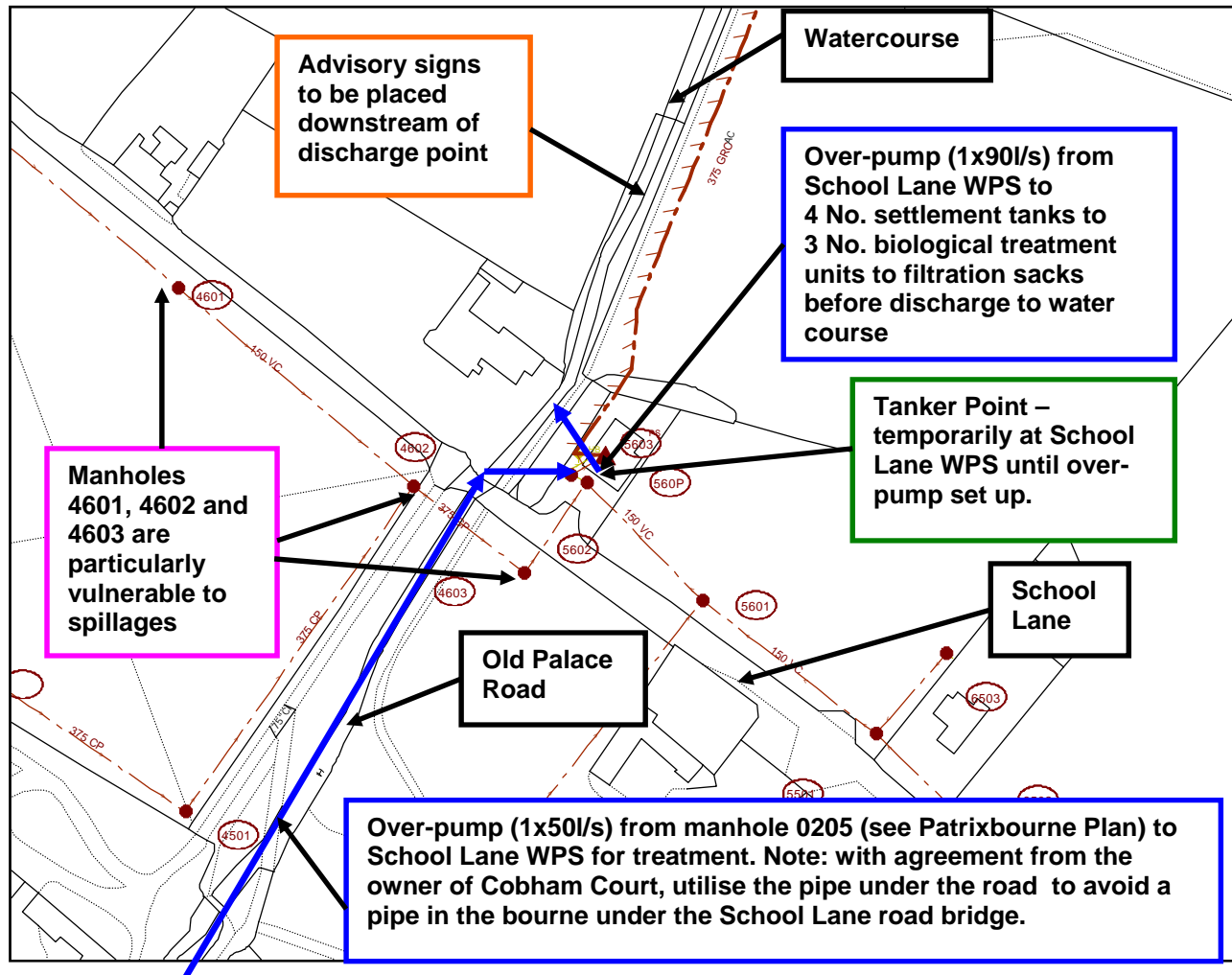

B5. Patrixbourne, Nailbourne, Kent – Over-pumping and Tankering Sites (Plan 1 of 2)

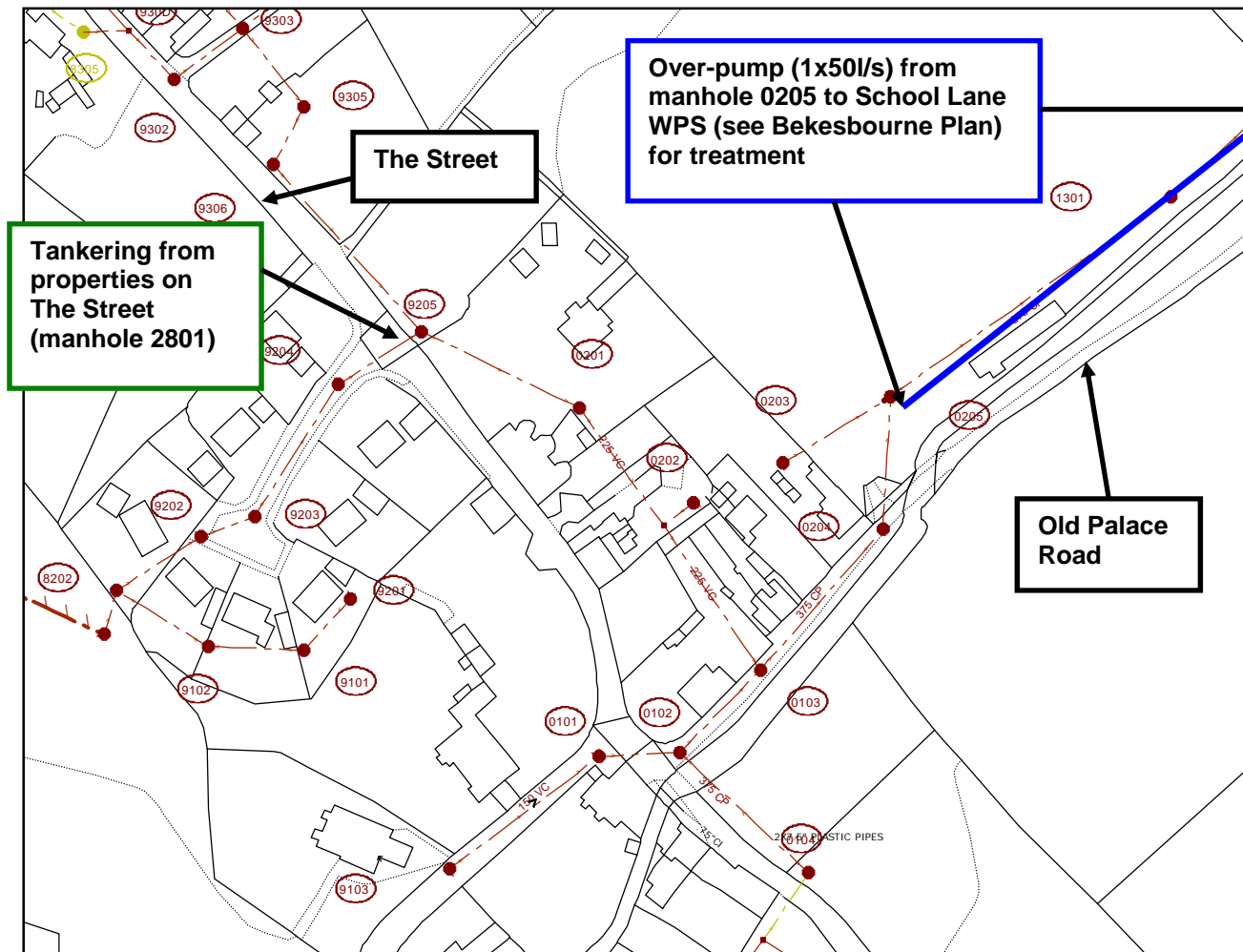

B6. Patrixbourne, Nailbourne, Kent – Over-pumping and Tankering Sites (Plan 2 of 2)

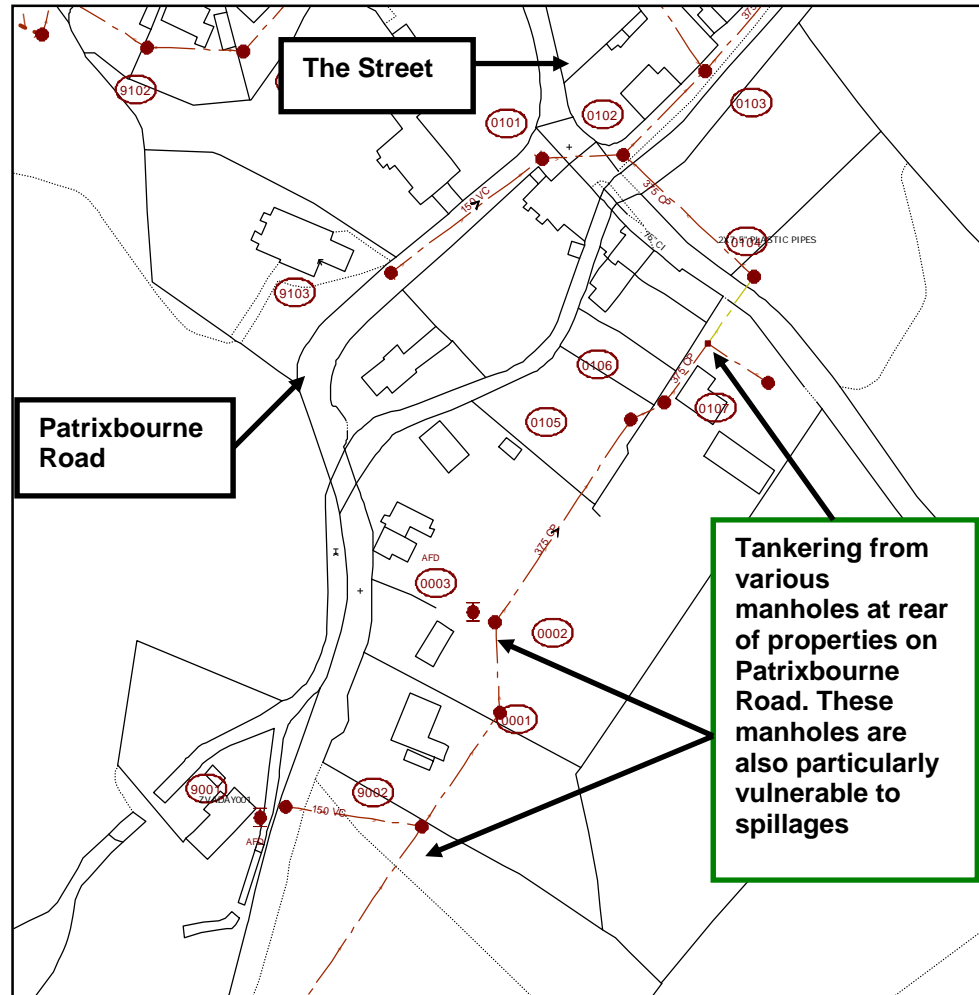

B7. Bridge, Nailbourne, Kent – Over-pumping and Tankering Sites (Plan 1 of 2)

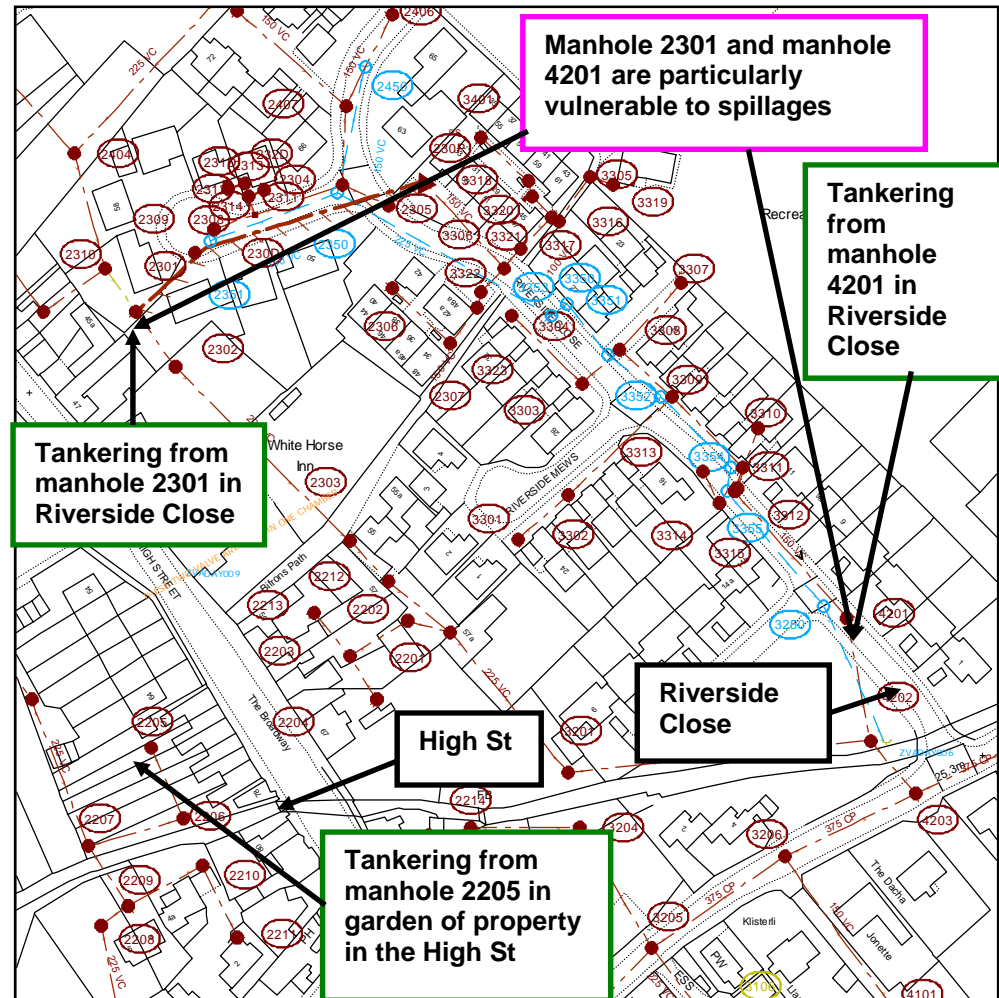

B8. Bridge, Nailbourne, Kent – Over-pumping and Tankering Sites (Plan 2 of 2)

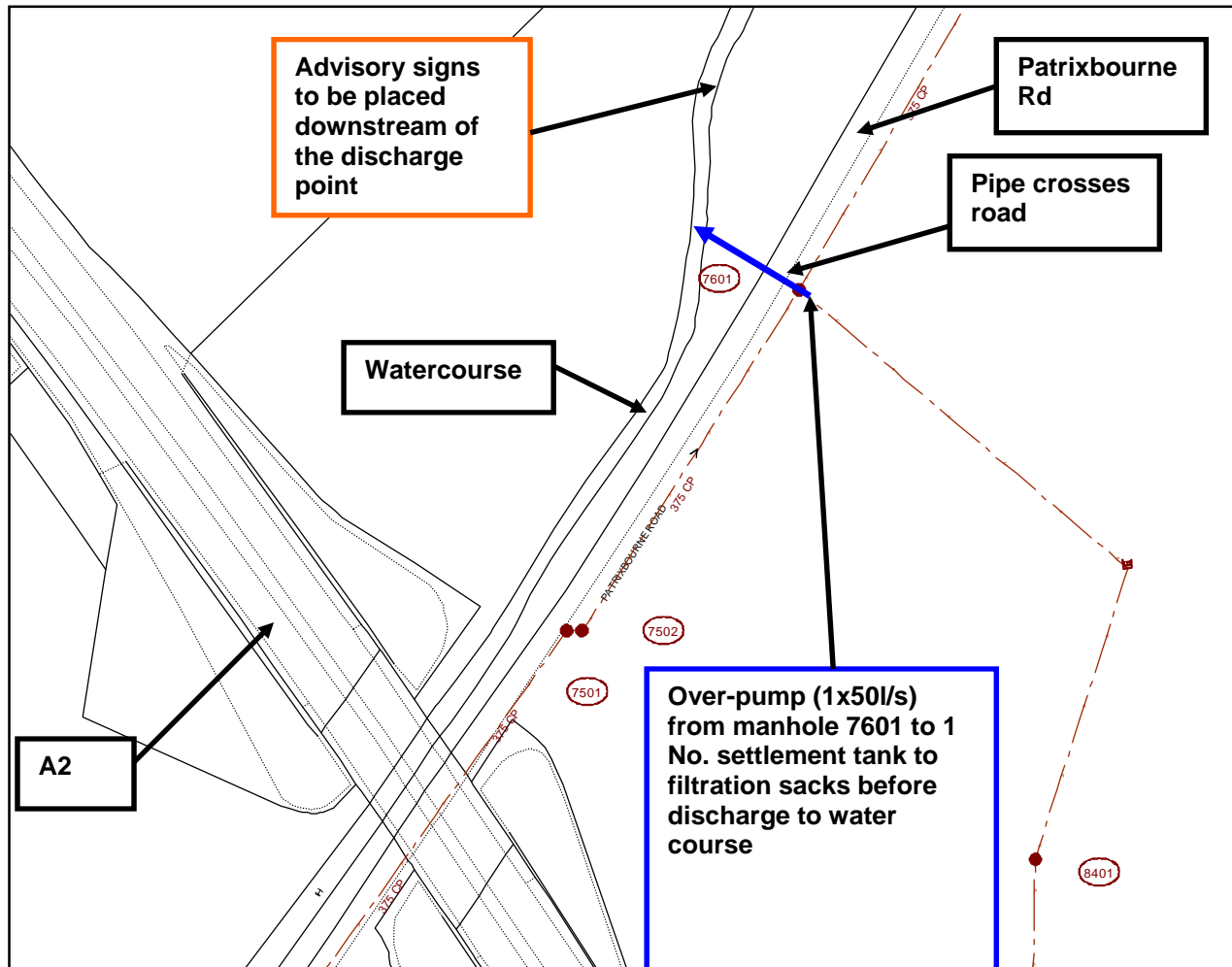

B9. Bishopsbourne, Nailbourne, Kent – Over-pumping and Tankering Sites (Plan 1 of 1)

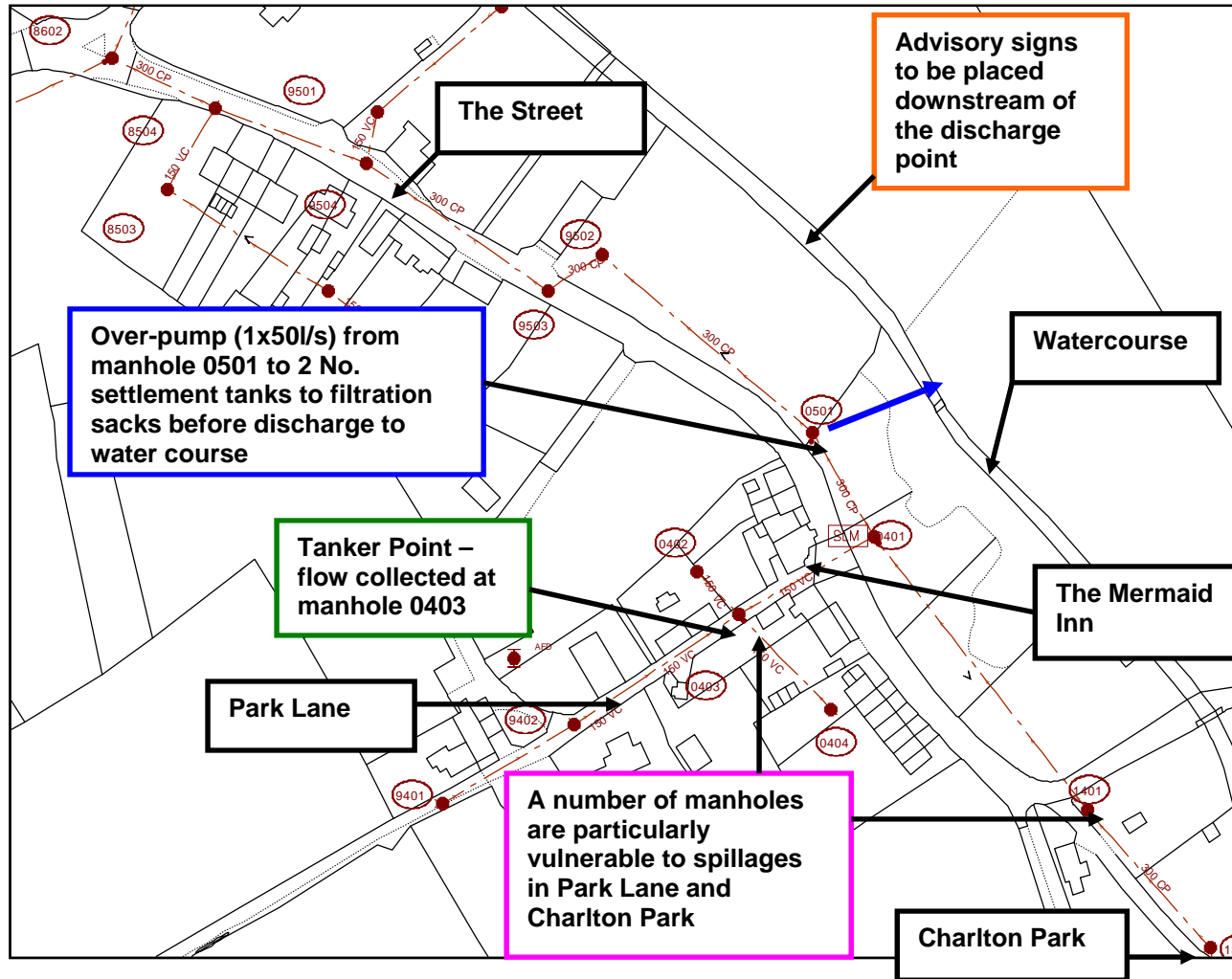

Approximate Timing for Deployment of Tankers and Over-pumps

Location	Tankering at Various Locations			Over-pumping			
	Start Date	Stop Date	Typical Number of Tankers	Over-pump Site Name	Start Date	Stop Date	Typical Number of Pumps
Winter 2013/14							
Ickham	12/02/14	15/03/14	2		N/A	N/A	N/A
Littlebourne	06/02/14	02/04/14	1	Nargate St WPS	05/02/14	14/04/14	1
Bekesbourne	23/01/14	03/02/14	3	School Lane WPS	28/01/14	28/05/14	2
Patricbourne	24/01/14	02/04/14	3	Old Palace Road	05/02/14	14/04/14	1
Bridge	26/02/14	02/04/14	3	Patricbourne Rd	One week in March/April 2014		N/A
Bishopsbourne	29/01/14	13/05/14	1	Mermaid Inn	29/01/14	15/05/14	1
Barham	13/02/14	06/03/14	1	Valley Road	24/02/14	08/04/14	1
Winter 2015/16							
Bishopsbourne	12/02/2016	13/2/2016	1	Used as a precautionary measure only			
Winter 2016/17 – no deployment of tankers or overpumps							
Winter 2017/18 - no deployment of tankers or overpumps							
Winter 2018/19 - no deployment of tankers or overpumps							

Nailbourne Lower - Infiltration Reduction Plan

Location	Tankering at Various Locations			Over-pumping			
	Start Date	Stop Date	Typical Number of Tankers	Over-pump Site Name	Start Date	Stop Date	Typical Number of Pumps
Winter 2019/20							
Bishopsbourne	Feb 20	May 20	1	No deployment			
Winter 2020/21							
Bishopsbourne	Feb 21	April 21	3	No deployment			
